

Trans-Positioner & Trans-Stacker - flexible handling of goods

High flexibility and efficiency - with only one truck, goods can be transported, lifted and handled in many different ways.

The design puts focus on the safety and ergonomic working conditions of the user - TS and TP can be adjusted to the individual user, and the ergonomic correct handle ensures the user a relaxed hold.

Optimum utilization of the space - TS and TP are of compact construction and are very maneuverable.

High quality is ensured through an extended test program and in cooperation with experts in Health and Safety.



TRANS-STACKER & TRANS-POSITIONER (LOGIFLEX)



Technical Specifications

- Optimum safety for the user through
- central location of all control buttons on the handle
 - transparent and impact-resistant safety screen on the mast
 - location of parking brake

Strong construction ensures a long operating life and low maintenance costs.



Ergonomic handle ensures the user a relaxed hold. The handle can be marked with the name/department.



High maneuverability: Short overall length, large turning angle, assisted steering and low own weight.



Adjustable forks are available as optional extra in many different lengths and types.

Available with manual and electric lifting.

Product (measured in inch)	TP-MM	TS-MM	TS-MM	TS-MM	TS-MM	TS-MM	TS-MM	TP-ME	TS-ME	TS-ME	TS-ME	TS-ME	TS-ME	TS-ME	TS-ME	TS-ME	
Capacity in lbs	2200	2200	2200	2200	2200	2200	2200	2200/3000	2200/3000	2200/3000	2200/3000	2200	2200	2200	2200	2200*	
Lifting height	h ₃	36	47	55	63	75	80	36	47	55	63	75	80	96	112	130	
Fork length	l	23.5**, 31.5**, 45, 60***						23.5**, 31.5**, 45, 60***									
Overall height	h ₁	52.5	60	68	76	88	60	68	52 1/2	60	68	76	88	60	68	76	88
Overall width	b ₁	27						27						932			
Fork span	b ₅	19, 22, 27	22, 27				19****, 22, 27		22, 27								
Length without forks	l ₂	16.38						23.25									
Overall length with 1150 forks	l ₁	64				64.38		71				71.25					
Overall height	h ₄	Without telescopic mast						98	114	Without telescopic mast				98	114	130	148
Lowered height	h ₁₃	3.25	3.25				3.25		3.25								
Load centre	c	l/2						l/2									
Fork width	e	6.5						6.5									
Run-in length	l _x	43 with 45 forks						43 with 45 forks									
Gangway (pallet: 1200 x 800)	A _{st}	84.5*****	86*****				88.5*****		90*****								
Free lift	h ₂					7.5						7.5					
Turning angle of the wheels		180°						180°									
Pump motor								1,1 kW 12 V									
Lifting speed		normal/quick: 0.3" / 1" per pump						With/without load: 2 / 2.75" per sec.									
Lowering speed with/without load		max. 7.5" per sec. / max. 2.8" per sec.						4.75" per sec. / 2.75" per sec.				4.75" / 3" per sec.					
Weight in lbs (without battery)		428	470	485	494	510	612	630	488	531	544	552	571	664	681	710	816

- * Load reduction at large lifting height.
- ** Maximum lifting height 63" with 23.5" forks, maximum lifting height 96" with 31.5" forks.
- *** Reduced capacity 1650 lbs. Not available for 3000 lbs. models.
- **** Only for 2200 lbs. models.
- ***** Tests show that 67" are enough.



Available with side-tilting forks and/or optional extras, e.g. drum turner, crane arm, spear, remote control, level control.

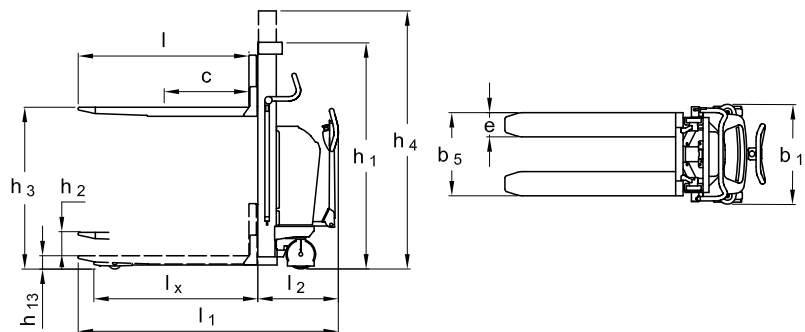

We also offer tailor-made solutions. Please ask for further information. Please ask for further information or visit our website www.interthor.com



Interthor Inc.
1817 Beach Street - Broadview, IL 60155 - USA
Tel.: 708-345-1270 - Fax: 708-345-1290
www.interthor.com - E-mail: info@interthor.com