

Distributed by Ergonomic Partners, Inc.
 Email: sales@ergonomicpartners.com
 Web: www.ergonomicpartners.com
 PH: 314-884-8884 | FAX: 800-570-5584

ITEM NO	QTY	PART NO	DESCRIPTION
1	1	DH-06501	FOLDING CRANK MECHANISM
2	1	DH-06500	HANDLE, CRANK, 5" ALUMINUM
3	1	DH-06003	PIN, SLOTTED SPRING, 1/8X1-1/4LG

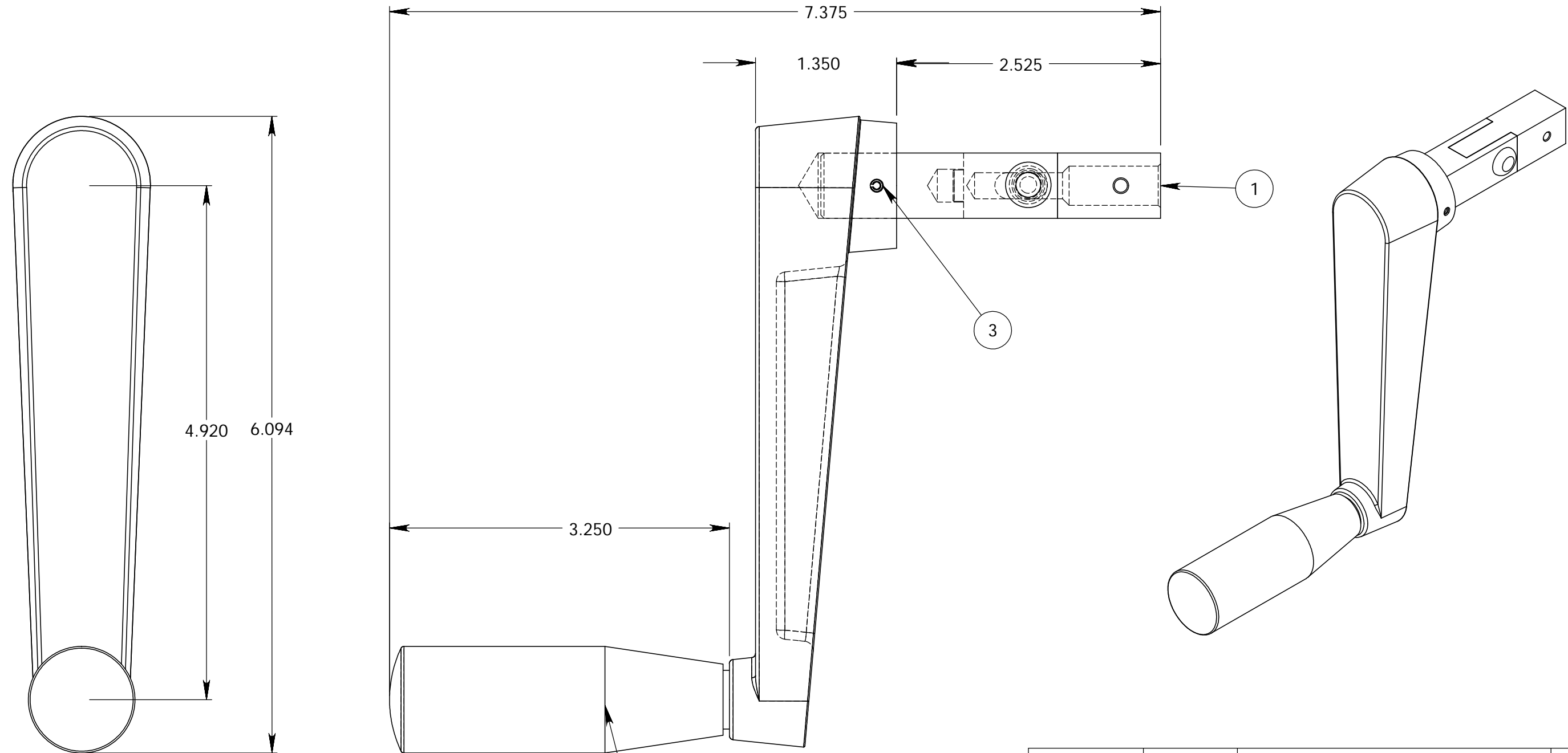

NOTES:

1. ALL DIMENSIONS ARE REFERENCE ONLY.

THIS PRINT IS THE PROPERTY OF MONARCH HYDRAULICS INC., AND IS NOT TO BE USED DIRECTLY OR INDIRECTLY IN ANY WAY DETRIMENTAL TO OUR INTEREST	NON-SPECIFIED TOLERANCES: .XX ± .010 .XXX ± .005 FRACT. ± 1/32 ANGLES ± 1/2° BREAK EDGES .005-.010 REMOVE BURRS	DESCRIPTION: CRANK ASSEMBLY, RETRACTABLE, 5" ALUMINUM HANDLE			SIZE: B
		CUSTOMER:			REV BY: BJW
		MONARCH HYDRAULICS INC. GRAND RAPIDS, MI USA	DATE: 4/30/1997	DRAWN BY: JED	REV DATE: 7/23/2004
		DO NOT SCALE	SHEET 1 OF 1	PART NO: DH-17100	ECN: 8517 REV: C

ITEM NO	DH-06510/QTY	PART NO	DESCRIPTION
1	1	DH-06508	CRANK MECHANISM
2	1	DH-06500	HANDLE,CRANK,5"ALUMINUM
3	1	01293	PIN,COTTER,1/8 DIA X 1-1/2
4	1	DH-06000	PIN,SLOTTED SPRING,1/8X5/8LG

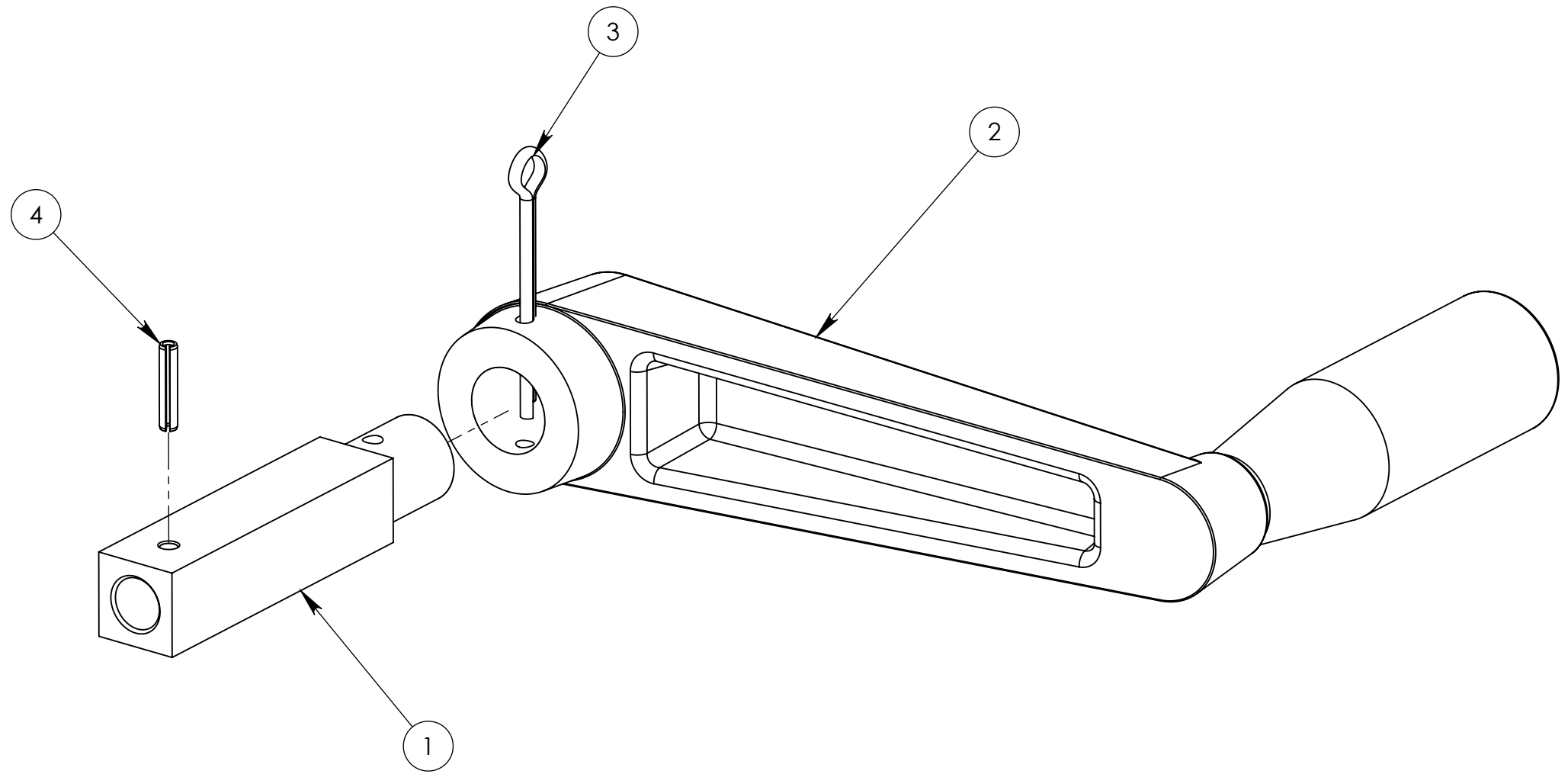

Distributed by Ergonomic Partners, Inc.
 Email: sales@ergonomicpartners.com
 Web: www.ergonomicpartners.com
 PH: 314-884-8884 | FAX: 800-570-5584

REV	DESCRIPTION			SIZE:
	DESCRIPTION: REMOVEABLE CRANK/HANDLE ASSEMBLY			B
	NON-SPECIFIED TOLERANCES: .XX ±.010 .XXX ±.005 FRACT. ± 1/32 ANGLES ± 1/2°			REV BY: -
	BREAK EDGES .005-.010 REMOVE BURRS			REV DATE:
	 GRAND RAPIDS, MI USA		CUSTOMER: N/A	EWR: 16532
	[MILLIMETER] INCH	DO NOT SCALE	DATE: 6/17/2011 DRAWN BY: MHS	REV: AA
		SHEET 1 OF:1	DRAWING #: DH-06510	

THIS PRINT IS THE PROPERTY OF BUCHER HYDRAULICS INC., AND IS NOT TO BE USED DIRECTLY OR INDIRECTLY IN ANY WAY DETRIMENTAL TO OUR INTEREST

