

Assembly Arms

Eliminate torque

Reduce operator fatigue

Maintain tool perpendicularity

Increase precision and productivity



705 Commerce Dr., Wapakoneta, OH 45895

Distributed by Ergonomic Partners

Sales@ErgonomicPartners.com

www.ErgonomicPartners.com

Tel: (314) 884-8884



Model	B-19 RG
Max Weight	25 lbs
Horz. Working Range	1"-56"
Vert. Working Range	-3.4"-16.9"

ROTATIONAL GIMBAL

P/N: 101100-101400

For use with Angle Grinders and Horizontal Grinders.

**Clamps are tool specific. Make and model of tool must be supplied with order.

P/N: 101500

For use with Vertical Grinders.

**Rotational sleeve is tool specific. Make and model of tool must be supplied with order.



P/N	101400	101100	101200	101300	101500
Size Range	Ø0"-Ø2.625"	Ø2.63"-Ø3.625"	Ø3.63"-Ø4.625"	Ø4.63"-Ø5.313"	N/A





Model	AR-40	AR-40-M
Max Torque	40 ft/lbs	40 ft/lbs
Weight Range	0-10 lbs	5-15 lbs
Working Range	4.25"-27"	4.25"-27"
Tool Clamp	1"-2.25"	1"-2.25"

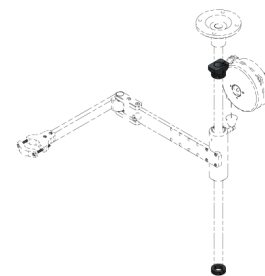

INVERSE MOUNTING KIT

P/N: 100050

Mounts arm overhead to free up workspace.

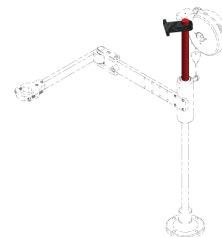

UPPER POLE CLAMP

P/N: 100051

Recommended accessory if the arm is frequently used at the top of its stroke (as indicated by the area highlighted red).

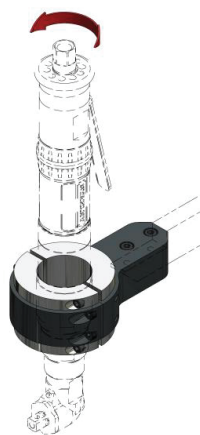

VERTICAL ROTATION CLAMP

P/N: 100031

For use with Right Angle Nut Runners when fastening orientation requirement is horizontal only.

**Clamp is tool specific. Make and model of tool must be supplied with order.

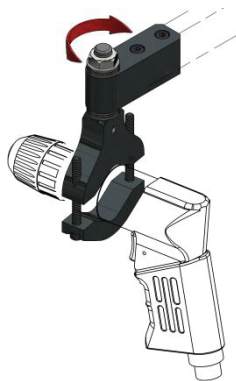

PISTOL GRIP V-BLOCK

P/N: 100025

For use with Pistol Grip Tools when fastening orientation requirement is horizontal only.

V-block fits tool $\varnothing 1" - 2.25"$

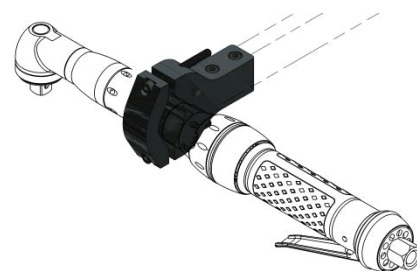

HORIZONTAL V-BLOCK

P/N: 100027

For use with Right Angle Nut Runners when fastening orientation requirement is vertical only.

V-block fits tool $\varnothing 1" - 2.25"$



Model	LR-40	LR-40-M
Max Torque	40 ft/lbs	40 ft/lbs
Weight Range	0-10 lbs	5-15 lbs
Working Range	8"-31.25"	8"-31.25"
Tool Clamp	1"-2.25"	1"-2.25"

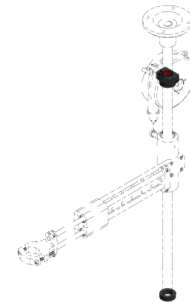

INVERSE MOUNTING KIT
P/N: 100050

Mounts arm overhead to free up workspace.

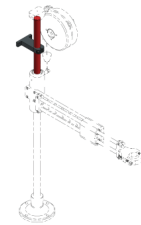

UPPER POLE CLAMP
P/N: 100051

Recommended accessory if the arm is frequently used at the top of its stroke (as indicated by the area highlighted red).

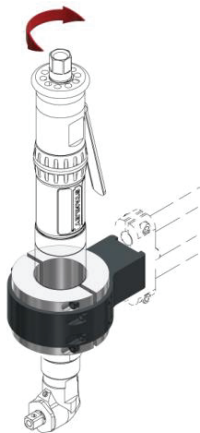

VERTICAL ROTATION CLAMP
P/N: 100119

For use with Right Angle Nut Runners when fastening orientation requirement is horizontal only.

**Clamp is tool specific. Make and model of tool must be supplied with order.

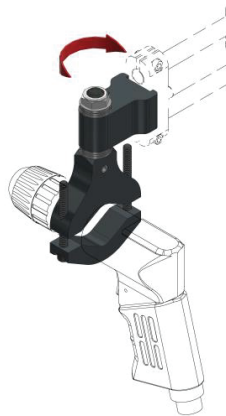

PISTOL GRIP V-BLOCK
P/N: 100114

For use with Pistol Grip Tools when fastening orientation requirement is horizontal only.

V-block fits tool \varnothing 1" -2.25"

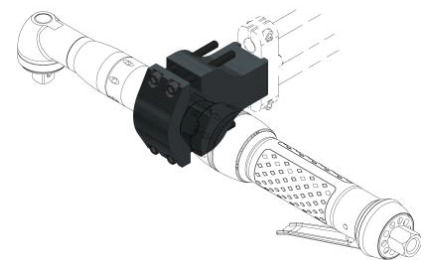

HORIZONTAL V-BLOCK
P/N: 100116

For use with Right Angle Nut Runners when fastening orientation requirement is vertical only.

V-block fits tool \varnothing 1" -2.25"



Benefits

- Robustness
- Counterbalance
- Working Range
- Ergonomics
- Perpendicularity

Model	S-36	M-60
Max Torque	80 ft/lbs	80 ft/lbs
Weight Range	1-25 lbs	1-14 lbs
Working Range	14"-51"	22"-76"
Tool Clamp	1"-2.25"	1"-2.25"

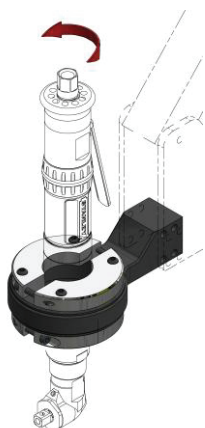

VERTICAL ROTATION CLAMP
P/N: 658582

For use with Right Angle Nut Runners when fastening orientation requirement is horizontal only.

**Clamp is tool specific. Make and model of tool must be supplied with order.
**Max tool diameter is 2.37"

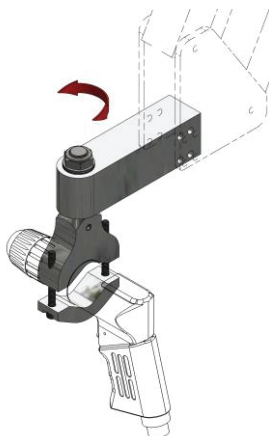

PISTOL GRIP V-BLOCK
P/N: 658581

For use with Pistol Grip Tools when fastening orientation requirement is horizontal only.

V-block fits tool $\varnothing 1" - 2.25"$

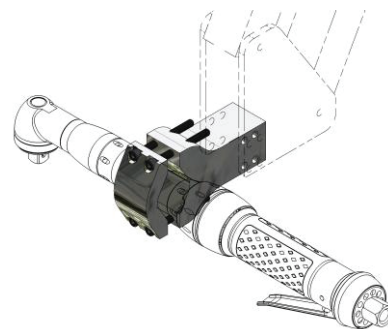

HORIZONTAL V-BLOCK
P/N: 658532

For use with Right Angle Nut Runners when fastening orientation requirement is vertical only.

V-block fits tool $\varnothing 1" - 2.25"$