

Logiflex - flexible handling of goods

High flexibility and efficiency - with only one truck, goods can be transported, lifted and handled in many different ways.

The design puts focus on the safety and ergonomic working conditions of the user - Logiflex can be adjusted to the individual user, and the ergonomic correct handle ensures the user a relaxed hold.

Optimum utilization of the space - Logiflex is of compact construction and is very maneuverable.

High quality is ensured through an extended test program and in cooperation with experts in Health and Safety.



LOGIFLEX LF MINI / ELF TRANS-STACKER & TRANS-POSITIONER



Technical Specifications

- Optimum safety for the user through
- central location of all control buttons on the handle
 - transparent and impact-resistant safety screen on the mast
 - location of parking brake

Strong construction ensures a long operating life and low maintenance costs.



Ergonomic handle ensures the user a relaxed hold. The handle can be marked with the name/department.



High maneuverability: Short overall length, large turning angle, assisted steering and low own weight.



Adjustable forks are standard for LF Mini and several ELF models.

Available with manual and electric lifting.

| Product (measured in inch) | LF MINI TP-MM MINI | LF MINI TS-MM MINI | ELF TP- ME | ELF TS-ME | ELF TP-ME | ELF TS-ME | ELF TS-ME | ELF TS-ME | | | | | | | |
|----------------------------------|-----------------------|---|---------------|---|--------------|---------------------------|--------------|--------------|------|-------|------|---------------------|-------|-----|--|
| Capacity in lbs | 2200 | 2200 | 2200 | 2200 | 3000 | 3000 | 3000 | 3000 | 2200 | 2200 | 2200 | 2200 | 2200* | | |
| Lifting height | h ₃ | 36 | 65 | 36 | 65 | 36 | 47 | 55 | 63 | 75 | 80 | 96 | 112 | 130 | |
| Fork length | l | 42, 45 | | 42, 45 | | 23.5**, 31.5**, 45, 60*** | | | | | | | | | |
| Overall height | h ₁ | 52.5 | | 52.5 | | | 60 | 68 | 76 | 88 | 60 | 68 | 76 | 88 | |
| Chassis span | b | 18.15, 21.25, 26 | | 18.15, 21.25, 26 | | 21.25, 26 | | | | | | | | | |
| Overall width | b ₁ | 27 | | 27 | | | | | | | | | 36.75 | | |
| Width between legs | b ₄ | 9.30, 12.45, 17.20 | | 9.30, 12.45, 17.20 | | 12.45, 17.20 | | | | | | | | | |
| Fork span | b ₅ | Wrap-over: 13.25-22 | | Wrap-over: 13.25-22 | | 22, 27 | | | | | | | | | |
| Length without forks | l ₂ | 16.35 | | 23.25 | | | | | | | | | | | |
| Overall length with 45 forks | l ₁ | 66 | 66.25 | 73.25 | 73.75 | 71 | | | | 71.25 | | | | | |
| Overall height | h ₄ | 52.5 | 79.75 | Without telescopic mast | 79.75 | Without telescopic mast | | | | 98 | 114 | 130 | 148 | | |
| Lowered height | h ₁₃ | 3.25 (fork span 22) 5,75 (fork span 13.25-21.75) | | 3.25 (fork span 22) 5,75 (fork span 13.25-21.75) | | 3.25 | 3.5 | | | | | | | | |
| Load centre | c | l/2 | | l/2 | | | | | | | | | | | |
| Fork width | e | 6.5 | | 6.5 | | | | | | | | | | | |
| Run-in length | l _x | 43 with 45 forks | | 43 with 45 forks | | | | | | | | | | | |
| Gangway (pallet: 47 x 31.5) | A _{st} | 86**** | | | | | | | | | | | | | |
| Free lift | h ₂ | | 13 | | 13 | | | | | | 7.5 | | | | |
| Turning angle of the wheels | | 180° | | 180° | | | | | | | | | | | |
| Pump motor | | | | | | | | | | | | | | | |
| Lifting speed | | normal/quick: 0.3" / 1" per pump | | With/without load: 2 / 2.75" per sec. | | | | | | | | | | | |
| Lowering speed with/without load | | max. 2" per sec. / max. 2.8" per sec. | | 4.75" per sec. / 2.75" per sec. | | | | | | | | 4.75" / 3" per sec. | | | |
| Weight in lbs (without battery) | | 485 | 560 | 524 | 626 | 503 | 531 | 503 | 572 | 594 | 693 | 700 | 742 | 858 | |

* Load reduction at large lifting height.

** Maximum lifting height 63" with 23.5" forks, maximum lifting height 96" with 31.5" forks.

*** Reduced capacity 1650 lbs. Not available for 3000 lbs. models.

**** Tests show that 67" are enough.



Available with side-tilting forks and/or optional extras, e.g. drum turner, crane arm, spear, remote control, level control.

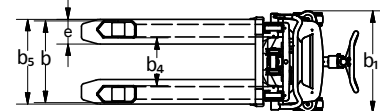
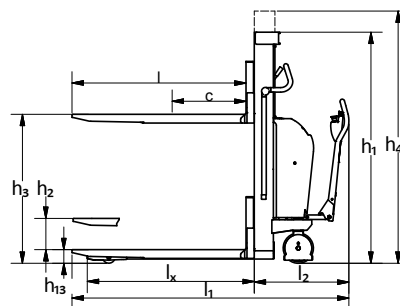

Interthor Inc.
1817 Beach Street - Broadview, IL 60155 - USA

Distributed by Ergonomic Partners
Email: sales@ergonomicpartners.com
Web: www.ergonomicpartners.com
PH: 314-884-8884 | FAX: 800-570-5584