



MAGNETEK
E N R A N G E

Flex VUE™ Transmitter

4, 8, and 12 Buttons

Technical Specifications

Transmitter Specification

Temperature Range:

- -25°C to 70°C (-13°F to 160°F)

Environmental Protection:

- IP66 and NEMA 4 Transmitter

Operation Range:

- Non-Licensed Part 15 Up to 300 feet (91.44 m)
- Non-Licensed FHSS Up to 3000 feet (914.4 m)

Frequency Range:

- Non-Licensed Part 15 433-434.75 MHz
- Non-Licensed FHSS 902-928 MHz / 2.4-2.5 GHz
- Government Band 405-430 MHz

Output Power:

- Non-Licensed Part 15 Less than 1mW
- Non-Licensed FHSS 50 mW, 125 mW
- Government Band 1mW

RF Channels

- Non-Licensed Part 15 32 channels
- Non-Licensed FHSS 32 channels
- Government Band Up to 1000 frequencies

Antenna:

- Internal

RF Type:

- TMS (Time Multiplexed Signaling)
- Microprocessor Controlled PLL synthesizer
- FHSS (Frequency Hopping Spread Spectrum)
- Transceiver

Response Time:

- Approximately 50 ms

Certifications:

- FCC & IC Approved Part 15

Weight:

- 4 button – 11 oz
- 8 button – 12.5 oz
- 12 button – 14 oz

Dimensions:

- 4 button – (LxWxH) 7.1" x 3.0" x 1.9" (179 x 76 x 47 mm)
- 8 button – (LxWxH) 8.9" x 3.0" x 1.9" (225 x 76 x 47 mm)
- 12 button – (LxWxH) 10.7" x 3.0" x 1.9" (271 x 76 x 47 mm)

Transmitter Component Specifications

Graphic Display:

- Backlit display
- 1.9" x 1.4" (48 x 36 mm)
- Multilingual with standard ACSII characters
- High resolution color

Pushbuttons:

- Two step (speed)
- Proportional (0 to 100%, interlocked and non-interlocked)

Proportional Button Configuration

- Each button can be configured as proportional, on/off momentary, or on/off latched. Other custom configurations are available. Please consult the factory for more information.

Adjustable Speed Control Settings for Proportional Buttons:

- 4 settings – 25%, 50%, 75%, and 100%

On/Off/Start Switch

- 3 position, removable power key lock out

E-stop Switch

- Push to activate, twist to deactivate

LED

- 1 multi-color green/red/blue - Status LED Indicator

USB:

- Programming Port

Infrared Port:

- Programming Port

Battery and Charger Options

Battery Type:

- Disposable: 2 AA Alkaline, 2300 mAh



MAGNETEK
E N R A N G E

Flex VUE™ Transmitter

4, 8, and 12 Buttons

Technical Specifications

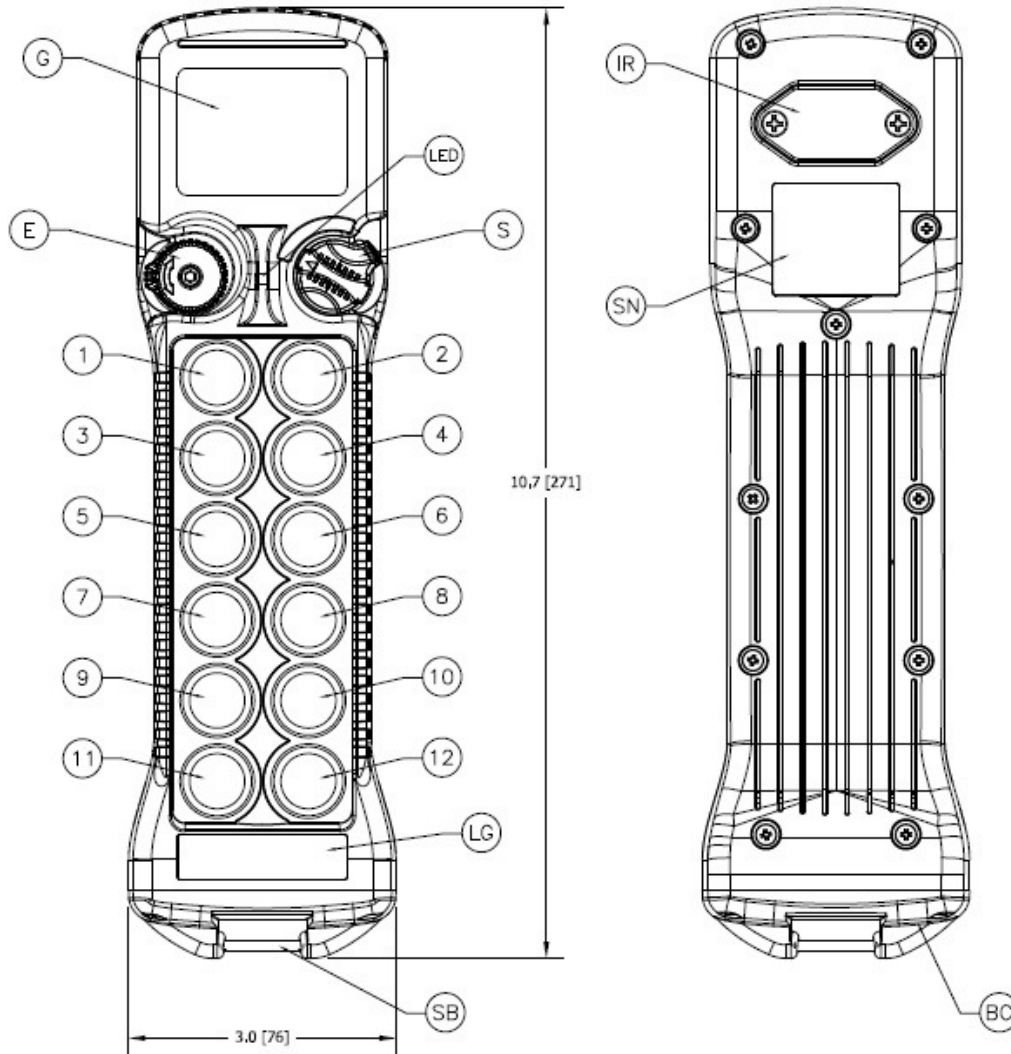

LAYOUT OF FLEX VUE 12 BUTTON

- | | | |
|-------------------------------|--------------------|-----------------------------|
| G. Graphic Display | 5. Pushbutton #5 | 12. Pushbutton #12 |
| E. Emergency Stop Button | 6. Pushbutton #6 | LG. Logo Label |
| S. Removable Power Key Switch | 7. Pushbutton #7 | SB. Strap Bar |
| 1. Pushbutton #1 | 8. Pushbutton #8 | IR. IR Communication Window |
| 2. Pushbutton #2 | 9. Pushbutton #9 | SN. System Information |
| 3. Pushbutton #3 | 10. Pushbutton #10 | BC. Battery Case |
| 4. Pushbutton #4 | 11. Pushbutton #11 | |

Distributed by Ergonomic Partners, Inc. | sales@ergonomicpartners.com | 314-884-8884 | www.ergonomicpartners.com

P.O. Box 13615
Milwaukee, WI 53213

N49 W13650 Campbell Drive
Menomonee Falls, WI 53051

Canada Facility
4090B Sladeview Crescent
Mississauga, Ontario
L5L 5Y5 Canada

Brochure No. Flex VUE
Tech Specs



MAGNETEK
E N R A N G E

Flex VUE™ Transmitter

Features and Benefits

| | FEATURES | BENEFITS |
|-------------|---|--|
| Comfort | One Handed Operation | Allows the user to easily control the equipment with one hand while freeing up the other hand for other tasks. |
| | Contoured, Ergonomically Designed | More comfortable for the operator to use. Proportional buttons offer smooth operation and low resistance, reducing hand fatigue. |
| | Handheld Style | Very lightweight and compact design, less likely to restrict the operators' movement and workflow. |
| Durability | Constructed of advanced polymer technology— super tough nylon | Resistant to most chemicals. Heat and shock resistant. Designed for an abusive industrial environment. |
| | Sealed electronics compartment – Flex VUE transmitters conform to IP66 and NEMA 4 standards | Protects components from chemicals, heat and other elements in abusive industrial environments. Designed to withstand dust, rain, water, and ice. |
| | Primary motion switches tested to over 1 million operations | Durable, rugged switches withstand continuous use and harsh environments. |
| Versatility | Universal Spare Transmitter | A spare transmitter can easily duplicate the settings of another transmitter using the Radio Control Programmer (RCP). This allows the user to replace a transmitter in the field with ease. |
| | Various Button Configurations | Proportional buttons can also be configured for On/Off Momentary, On/Off Latched, 2 speed, or 3 speed operation. |
| Components | Proportional Pushbuttons | Offers the user smooth, stepless operation. |
| | Two-Step Pushbuttons | With two-step pushbuttons, the operator will know the exact speed of operation with the mechanical detents. |
| | USB Port | Easily downloadable firmware upgrades, user settings. |
| | Infrared Port | Allows user to easily match the transmitter with a given receiver |
| | LED | Informative LED gives visual indication of the status of the transmitter. |
| | Batteries | Standard AA Alkaline batteries provide for long hours of operation. |

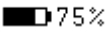
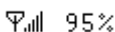

| | FEATURES | BENEFITS |
|-----------------|---|---|
| Graphic Display | Software Controlled Setup Mode | Allows the user to quickly change any configuration setting (channel, access code, time out) on the transmitter through easily understood menus without having to open the device. |
| | Visual Command Confirmation | Gives visual feedback confirmation on the display of which command is being operated. |
| | Battery Life Indicator  75% | Shows remaining battery life percentage in 5% increments so you know when your battery needs to be changed. |
| | Signal Strength Indicator  95% | Find the best location to operate at and be certain your signals are getting through. |
| | Self-Diagnostics | Scans all switches on startup to be sure no switches are on, and performs RF calibration. |
| | Two-Way Feedback System | Can be programmed to display parameters measured at the receiver such as weight of a load, drive speed, current, CAN-bus parameters, etc. Gives user info needed to safely or more efficiently operate the crane. |
| Performance | Adjustable Speed Control (ASC) | Gives the user four selectable ranges (0-100%, 0-75%, 0-50%, 0-25%) for more precise control at lower speeds. |
| | Electronically Synthesized Frequency Generation | Easily change frequencies in the field without concern about breaking crystals. |
| | Digitally Encoded Message | A highly secure and intelligent signal will only operate the intended equipment. |
| | Part 15 Unlicensed Operations | Up to 32 channels available in the ranges of 430-439.8 MHz, 902-928 MHz, and 2.4-2.5 GHz. Allows you to “tune” the system for your environment and to avoid on channel interference. |
| | FHSS Available in 2.4 GHz | Reliable in conditions with extreme RF interference. High power, long distance communication. |

Distributed by Ergonomic Partners, Inc. | sales@ergonomicpartners.com | 314-884-8884 | www.ergonomicpartners.com